

WICKED PLANTS

THE EXHIBIT

EXHIBIT GUIDE

Produced by:



The NORTH CAROLINA
ARBORETUM

INTRODUCTION

Visitors will discover the evildoers of the plant world lurking in their own homes and backyards through *Wicked Plants: The Exhibit*.

Inspired by Amy Stewart's best-selling book "Wicked Plants: The Weed that Killed Lincoln's Mother and other Botanical Atrocities," this fun-filled, family-friendly traveling exhibit gives visitors a safe, hands-on experience with some of the world's most diabolical botanicals. Two- and three-dimensional interactives fill a Victorian-era ramshackle home, where visitors travel from room to room and learn about some of Mother Nature's most appalling plant creations.



Based on the book:
"Wicked Plants: The Weed that Killed Lincoln's Mother and other Botanical Atrocities" by Amy Stewart, Algonquin Press, New York, N.Y. © 2009



CONTENT

Wicked Plants is designed to educate the general public about plants that are harmful to the human body and increase scientific literacy regarding the use of harmful plants and plant derivatives. Using an open-ended teaching method, this exhibit educates visitors — particularly school-age youth — about botany, health care and wellness, and demonstrates the actual biochemical, physical and neurological processes between plants and the human body.

Visitors will step into an eerie world where plants hold all the power. Showcasing more than 100 plants, this exhibit uses interactive displays to inform guests about plants associated with a myriad of health effects, including pain, addiction, obesity, allergies, cognitive impairment and even death. By incorporating history, storytelling and science, *Wicked Plants* provides visitors with a treasure trove of bloodcurdling botany that will entertain, alarm and enlighten.

WWW.WICKEDPLANTSEXHIBIT.COM

EXHIBIT WALKTHROUGH

1) Upon entering a decrepit old Victorian home, visitors are introduced to the crime family of the plant world, the deadly nightshades. Discover a veritable rogues gallery with portraits of intriguing characters, foul plants of the floral trade and signals used by plants and animals to defend themselves.



2) Weeds of mass destruction have overtaken the conservatory where 10 of the world's most virulent invasive plants wind their way through this featured hub of the exhibit, which can serve as a portal to other rooms.



3) People can lose themselves in books, but in the *Wicked Plants* library visitors will find themselves discovering what happens when plants affect brain chemistry. Using five interactive computers, random experiences and personalized quizzes, visitors can explore the potential risks and unpredictable outcomes associated with using plant derivatives.

4) A crime scene in the potions laboratory teaches visitors that things aren't always what they seem, especially in the plant world of survival. Visitors will search for clues throughout the room to solve the mysterious death of the home's last remaining occupant.



5) The terrible toxicodendrons in the parlor can really get under one's skin, literally! Visitors will have the chance to play mad scientist by deducing how various plants adapt to threats in their environments.



6) Supper served in the dining room could be one's last. Here visitors will learn from vampires, settlers and scientists that even the most mundane foods can be poisonous under certain circumstances.

7) From poison ivy to poison arrows, a collection of weaponry in the hall uses plant derivatives to immobilize the heart and lungs. See the painful inspiration behind Velcro® up close and a vanishing weapon of the Russian KGB that uses one of the most powerful plants on earth.

EXHIBIT WALKTHROUGH

8) In the bathroom, take a whiff of some of the plant world's smelliest mistfits. From skunk to rotting meat, visitors will find botanicals that stink, burn and explode. Find out how these organisms adapt to make themselves the most unappealing to prey.



9) Ghosts in the bedroom will tell you that there is no way out, for ordeal by poison is a one-way ticket for the accused.



10) Outside in the graveyard, visitors will encounter a slew of species that are on the offensive — oozing, exploding, stabbing, stinging, blistering, biting and causing pure agony that can last for years. See the tomb of Abraham Lincoln's mother and find out how she succumbed to her botanical battle.

11) Additional interpretation and props are available to create a living plant collection, either outdoors or in a greenhouse. Visitors will discover 24 of the most beautiful and common wicked species found in homes and landscapes — all available at your local garden center or nursery.



"The N.C. Arboretum did a wonderful job creating the Wicked Plants exhibition. In addition to producing a very creepy environment that kids love, they have presented some light-hearted, easy-to-understand content that makes it fun and easy for families to enjoy learning about plant evolution. It's a fun exhibit!"

-- Florida Museum of Natural History

"Wicked Plants gave our visitors an understanding of the darker side of botany. The derelict mansion layout created an immersive environment to explore while the text and videos provided clear scientific and historic content. We appreciated that the exhibition team at The North Carolina Arboretum was willing to work with us to fit the exhibit into our gallery space."

-- Pink Palace Museum

MAP OF THE EXHIBITION

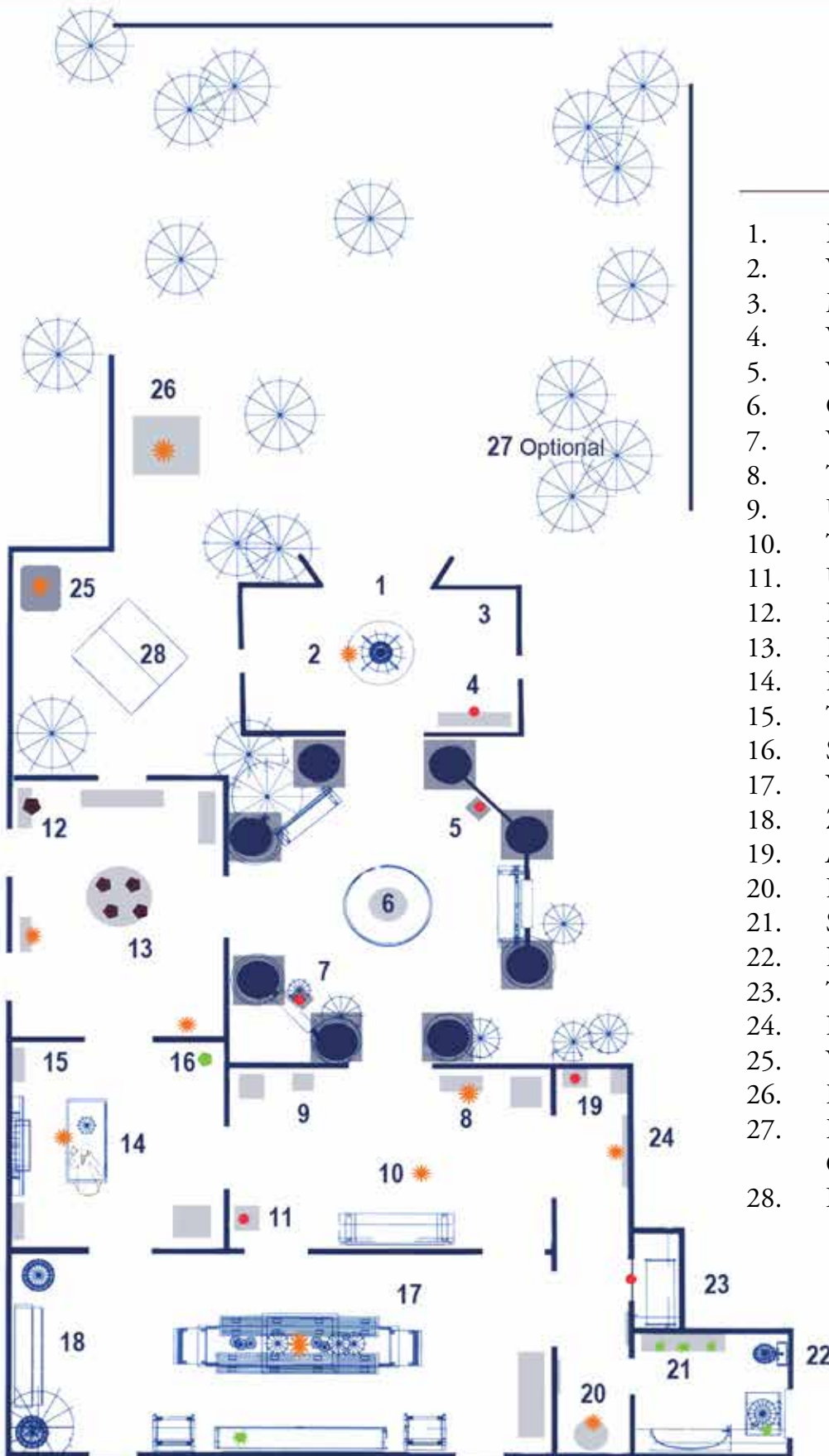

1. Deadly Bouquet
2. Visual History of Aconite
3. Meet the Nightshades
4. Warning Signals
5. Weeds of Mass Destruction
6. Conservatory
7. Water Plants Wrath
8. Toxicodendrons
9. Urushi Mummy
10. There's No Cashew There
11. Underneath a Mango Tree
12. Psychoactive Library
13. Brain-altering Botanicals
14. How Did Bella Die?
15. This is Not a Carrot
16. Survival of the Fittest
17. Your Last Supper
18. Zymology 101
19. Are you Feeling Numb?
20. Hang On
21. Stinky Station
22. Burning Bowl of Fire
23. Trial by Ordeal
24. Poisoned Weapons
25. You Have a Teddy Bear on You
26. Duck and Cover
27. Forbidden Garden: The Living Collection
28. Lincoln's Mother

- INTERACTIVE
- SMELL STATION
- COMPUTER STATION
- AUDIO VISUAL



EXHIBIT SPECIFICATIONS

- Size: 2,500-4,500 square feet; optional living collection plant list for outdoors or greenhouse available. Height requirement is 10 feet. Standard lighting; 110v drops and floor outlets.
- Loan Period: 3 months
- Rental Fee: \$65,000
- Shipping: One-way inbound, paid by host venue
- Security: Standard; camera or guard preferred
- Standard HVAC climate control
- Insurance: Standard
- Appropriate for natural history museums, science centers, botanical and zoological gardens.

INCLUDES:

- All walls, props and exhibit units (10 Rooms). *Living collection room optional with props and 23 interpretive panels included; host venue provides plants.*
- Operations manuals
- Five educator guides
- Speaking engagement and book signing opportunity with author Amy Stewart (paid by lender).
- Marketing kit

CONTACT

For more information or to request a booking,

- **Visit:** www.wickedplantsexhibit.com
- **Email:** exhibits@ncarboretum.org
- **Call:** 828-665-2492 x. 220



*Wicked Plants is produced by
The North Carolina Arboretum and funded in
part by the Creel-Harison Foundation*





“A tree that sheds poison daggers; a glistening red seed that stops the heart; a shrub that causes paralysis; a vine that strangles; and a leaf that triggered a war...”

WWW.WICKEDPLANTSEXHIBIT.COM